



# FUTURE

MOBILITY PRODUCTS INC.  
WWW.FUTUREMOBILITY.COM  
TOLL FREE 1-855-938-8873

1 Buffalo Rive Place Buffalo, NY, 14210



**SuperChair for Kids**

### Account Information

Account #: \_\_\_\_\_  
Business Name: \_\_\_\_\_  
Ship to Address: \_\_\_\_\_  
Fax: \_\_\_\_\_  
Contact: \_\_\_\_\_

Order Date: \_\_\_\_\_

P.O.#: \_\_\_\_\_

Phone: \_\_\_\_\_

City: \_\_\_\_\_

State: \_\_\_\_\_

Zip Code: \_\_\_\_\_

The HCPCS codes provided are based on code verification by the PDAC or our interpretation of the code definitions. Proper use of HCPCS codes does not ensure coverage or payment. For coverage information, verify the appropriate payer's coverage policy.

Prices are subject to change without notice

Item	Parts #	E-Code	Retail Price
<b>1. FRAME TYPE</b>			
<input type="checkbox"/> SuperChair For Kids	104CT1	E1233	\$2,765.00
<b>2. FRAME FINISH</b>			
<input type="checkbox"/> Black (Standard)	104C01	-	No Charge
<input type="checkbox"/> Silver	104C02	-	No Charge
<input type="checkbox"/> Blue	104C03	-	No Charge
<input type="checkbox"/> Orange	104C05	-	No Charge
<input type="checkbox"/> Purple	104C06	-	No Charge
<input type="checkbox"/> Red	104C07	-	No Charge
<input type="checkbox"/> Yellow	104C08	-	No Charge
<input type="checkbox"/> Burgundy	104C11	-	No Charge
<input type="checkbox"/> Custom Colors	104C17	-	\$300.00
<b>3. SEAT WIDTH</b>			
<input type="checkbox"/> 10" Seat Width	104W10	-	No Charge
<input type="checkbox"/> 11" Seat Width	104W11	-	No Charge
<input type="checkbox"/> 12" Seat Width	104W12	-	No Charge
<input type="checkbox"/> 13" Seat Width	104W13	-	No Charge
<input type="checkbox"/> 14" Seat Width	104W14	-	No Charge
<input type="checkbox"/> 15" Seat Width	104W15	-	No Charge
<input type="checkbox"/> 16" Seat Width	104W16	-	No Charge
<b>4. SEAT DEPTH</b>			
<input type="checkbox"/> 11" Seat Depth	104SD11	-	No Charge
<input type="checkbox"/> 12" Seat Depth	104SD12	-	No Charge
<input type="checkbox"/> 13" Seat Depth	104SD13	-	No Charge
<input type="checkbox"/> 14" Seat Depth	104SD14	-	No Charge
<input type="checkbox"/> 15" Seat Depth	104SD15	-	No Charge
<input type="checkbox"/> 16" Seat Depth	104SD16	-	No Charge
<b>5. SEAT TO FLOOR HEIGHT</b>			
<input type="checkbox"/> 17.5" Seat to Floor (20" Wheels & 4" Casters)	104STF62	-	No Charge
<input type="checkbox"/> 18" Seat to Floor (20" Wheels & 4" Casters)	104STF63	-	No Charge
<input type="checkbox"/> 18.5" Seat to Floor (22" Wheels & 5" Casters)	104STF64	-	No Charge
<input type="checkbox"/> 19" Seat to Floor (22" Wheels & 7" Casters)	104STF60	-	No Charge
<input type="checkbox"/> 19.5" Seat to Floor (22" Wheels & 7" Casters)	104STF61	-	No Charge
<input type="checkbox"/> 19.75" Seat to Floor (22" Wheels & 8" Casters)	104STF65	-	No Charge
<input type="checkbox"/> 18.5" Seat to Floor (12" Wheels & 5" Casters)	104STF66	-	No Charge
<input type="checkbox"/> 19" Seat to Floor (12" Wheels & 7" Casters)	104STF67	-	No Charge
<input type="checkbox"/> 19.5" Seat to Floor (12" Wheels & 7" Casters)	104STF68	-	No Charge
<input type="checkbox"/> 20" Seat to Floor (12" Wheels & 8" Casters)	104STF69	-	No Charge

### Standard Chair Includes:

Rigid Tilting Frame w/Swingaway Front End  
 Round Heavyduty Crossbrace Tubing  
 Seat Width 10"-16"  
 Seat Depth 11"-16"  
 Seat to Floor Height Front 17.50"-20"  
 Seat to Floor Height Rear 15.75"-18.5"  
 Rear Wheel Options 12", 20" or 22"  
 Handrim Option (Stainless Steel or Plastic Coated)  
 Caster Options 4", 5", 7" or 8"  
 Adjustable Height Full Length Arm (vinyl pad) T-Style  
 Angle Adjustable 10 deg Bend Cane w/Push bar - High  
 70 Degree Swingaway Front Riggings  
 Composite Flip-Up Footplate  
 Wheel Locks (Push or Pull to Lock)  
 Side Storage Pocket  
 Padded Headrest (Kids or Small)  
 Choice of Seven Colours (Black, Blue, Burgundy, Orange, Yellow, Red or Silver)



SUPERCHAIR FOR KIDS FRONT STF HEIGHT AVAILABILITY					
<b>4" CASTER</b>					
REAR WHEEL					
12"					
20"	17.5"	18"			
22"					
<b>5" CASTER</b>					
REAR WHEEL					
12"			18.5"		
20"					
22"			18.5"		
<b>7" CASTER</b>					
REAR WHEEL					
12"			19"	19.5"	
20"					
22"			19"	19.5"	
<b>8" CASTER</b>					
REAR WHEEL					
12"				20"	
22"				19.75"	

Item	Parts #	E-Code	Retail Price
<b>6. REAR WHEEL RIM</b>			
<input type="checkbox"/> Mag Wheels	104RW09	-	No Charge
<input type="checkbox"/> Spoke Wheels	104RW10	-	\$75.00
<b>7. REAR WHEEL TIRE</b>			
<input type="checkbox"/> Airless (Solid Rubber)	104RT1	-	No Charge
<input type="checkbox"/> Pneumatic (Only Available for 20" or 22")	104RT2	E2211	\$90.00
<b>8. HANDRIM</b>			
<input type="checkbox"/> Chrome	104HR1	-	No Charge
<input type="checkbox"/> Plastic Coated	104HR2	K0059	\$160.00
<input type="checkbox"/> No Handrims	104HR3	-	No Charge
<b>9. ARM TYPE</b>			
<input type="checkbox"/> T-Style Adjustable Height Pin Release	104AR05	E0973	No Charge
<input type="checkbox"/> T-Style Fixed Height	104AR02	E0973	No Charge
<input type="checkbox"/> Cantilever Arm Adj. Angle	104AR11	E0973	\$225.00
<input type="checkbox"/> Cantilever Arm Adj. Angle with Guard	104AR12	E0973	\$320.00
<b>10. ARM PAD TYPE</b>			
<input type="checkbox"/> Desk length Vinyl 10" (pair)	104AP1	-	No Charge
<input type="checkbox"/> Full length Vinyl 14" (pair)	104AP2	-	No Charge
<input type="checkbox"/> Contour Gel 17" (pair)	104AP3	-	No Charge
<b>11. BACK POST</b>			
<input type="checkbox"/> Angle Adj 10 deg Bend w/Push Handle (low)	104SP3	-	No Charge
<input type="checkbox"/> Angle Adj 10 deg Bend w/Push Handle (high)	104SP4	-	No Charge
<input type="checkbox"/> Angle Adj 10 deg Bend w/o Push Handle (low)	104PC3	-	No Charge
<input type="checkbox"/> Angle Adj 10 deg Bend w/o Push Handle (high)	104PC4	-	No Charge
<b>12. BACK POST HEIGHT</b>			
<input type="checkbox"/> 10" Post Height	NA	-	No Charge
<input type="checkbox"/> 12" Post Height	NA	-	No Charge
<input type="checkbox"/> 14" Post Height	NA	-	No Charge
<input type="checkbox"/> 16" Post Height	NA	-	No Charge
<b>13. BACK OPTIONS</b>			
<input type="checkbox"/> No Back	104BK49	-	Standard
<input type="checkbox"/> Super Chair Kids Back Stock	104BK75	E2620	\$695.00
<input type="checkbox"/> Super Chair Kids Back Non Stock	104BK76	E2620	\$695.00
<input type="checkbox"/> Super Chair Kids Back Custom	104BK77	E2620	\$745.00
<input type="checkbox"/> Slip-on Padded Back Upholstery	104BK48	-	\$150.00
<input type="checkbox"/> Prism Basic Back 14-20" wide	BB14-20	E2620	\$615.00
<input type="checkbox"/> Prism Ultra Back 14-20" wide	UB14-20	E2620	\$615.00
<input type="checkbox"/> Prism Air Back 14-20" wide	AB14-20	E2615	\$655.00
<input type="checkbox"/> Prism TrueFitt Back 14-20" wide	TFB14-20	E2615	\$625.00
<input type="checkbox"/> Prism Max Ultra Back 14-20" wide	MUB14-20	E2620	\$645.00
<input type="checkbox"/> Prism Max Air Back 14-20" wide	MAB14-20	E2620	\$725.00
<input type="checkbox"/> Prism Max TrueFitt Back 14-20" wide	MTFB14-20	E2620	\$675.00
<b>14. BACK PINS</b>			
<input type="checkbox"/> Not Required	NA	-	No Charge
<input type="checkbox"/> Longer Pins for Back H/Ware 1" Growth	104BP1	-	\$50.00
<input type="checkbox"/> Longer Pins for Back Hardware 2" Growth	104BP2	-	\$50.00

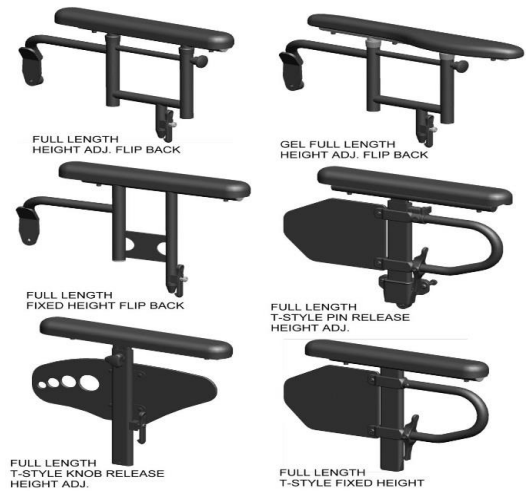

Item	Parts #	E-Code	Retail Price
------	---------	--------	--------------

15. SEAT PAN OPTIONS			
<input type="checkbox"/> Not Required	NA	-	No Charge
<input type="checkbox"/> Expandable Seat Pan	104SE01	E2231	\$150.00
<input type="checkbox"/> Prism Drop Base FM	104SC36	E2231	\$100.00
<input type="checkbox"/> Prism Drop Base 1"	104SC37	E2231	\$100.00
<input type="checkbox"/> Prism Drop Base 2"	104SC38	E2231	\$100.00
<input type="checkbox"/> Prism Adjustable Drop Base	104SC42	E2231	\$150.00

16. SEAT CUSHION			
<input type="checkbox"/> No Cushion	104SC20	-	Standard
<input type="checkbox"/> Super Chair Kids Cushion Stock	104SC44	E2607	\$365.00
<input type="checkbox"/> Super Chair Kids Cushion Non Stock	104SC45	E2607	\$365.00
<input type="checkbox"/> Super Chair Kids Cushion Custom	104SC46	E2607	\$450.00
<input type="checkbox"/> Prism Ideal Cushion	104SC03	E2601	\$100.00
<input type="checkbox"/> Prism Elite Cushion	104SC06	E2603	\$225.00
<input type="checkbox"/> Prism Supreme Cushion	104SC09	E2607	\$365.00
<input type="checkbox"/> Prism Supreme Air Cushion	104SC15	E2624	\$475.00
<input type="checkbox"/> Prism Supreme II Plus	104SC12	E2607	\$385.00

17. FRONT RIGGING			
<input type="checkbox"/> 70° Swingaway	104FR04	-	No Charge
<input type="checkbox"/> 80° Swingaway	104FR19	-	\$97.00
<input type="checkbox"/> 90° Swingaway	104FR05	-	\$97.00
<input type="checkbox"/> Swingaway Elevating Legrest (pair)	104FR10	E0990	\$275.00
<input type="checkbox"/> No Front Rigging	104FR11	-	No Charge

18. FOOTPLATE			
<input type="checkbox"/> Super Chair Kids Aluminum Flip-Up Footplate - Small	104FP13	-	No Charge
<input type="checkbox"/> Super Chair Kids Aluminum Flip-Up Footplate - Medium	104FP14	-	No Charge
<input type="checkbox"/> Super Chair Kids Aluminum Flip-Up Footplate - Large	104FP15	-	No Charge
<input type="checkbox"/> Composite Flip Up Footplates - Small	104FP01	-	No Charge
<input type="checkbox"/> Aluminum Flip Up Footplates - Medium	104FP06	-	\$48.00
<input type="checkbox"/> Aluminum Angle Adj Flip Up Footplates - Small	104FP10	K0040	\$120.00

19. FOOTREST/LEGREST ACCESSORIES			
<input type="checkbox"/> Heel Loops	104FA01	K0951	\$40.00
<input type="checkbox"/> No Heel Loops	104FA02	-	No Charge
<input type="checkbox"/> Padded Calf Strap	104FA03	K0038	\$45.00
<input type="checkbox"/> Foam Pad on Footplate (pair)	104FA07	-	\$45.00

20. WHEEL LOCKS			
<input type="checkbox"/> Push to Lock	104WL1	-	No Charge
<input type="checkbox"/> Push to Lock + Wheel Lock Extension	104WL3	E0961	\$60.00
<input type="checkbox"/> Pull to Lock	104WL2	-	No Charge
<input type="checkbox"/> Pull to Lock + Wheel Lock Extension	104WL4	E0961	\$60.00

21. HEADREST HARDWARE			
<input type="checkbox"/> Omit Headrest Hardware	104HE99	-	Standard
<input type="checkbox"/> Fixed Headrest Hardware	104HE01	E0955	\$195.00
<input type="checkbox"/> Fixed Headrest Hardware Assembly (Plus 4")	104HE02	E0955	\$200.00
<input type="checkbox"/> Single Multi Axial Headrest Hardware	104HE03	E0955	\$217.00
<input type="checkbox"/> Single Multi Axial Headrest Hardware (+ 4")	104HE04	E0955	\$222.00
<input type="checkbox"/> Dual Multi Axial Headrest Hardware	104HE05	E0955	\$219.00
<input type="checkbox"/> Dual Multi Axial Headrest Hardware (Plus 4")	104HE06	E0955	\$225.00
<input type="checkbox"/> Links Multi Adj. Headrest (Comes with 2 links)	104HE10	E0955	\$240.00
<input type="checkbox"/> Links Multi Adj. Curved Headrest (Comes with 2 links)	104HE11	E0955	\$240.00

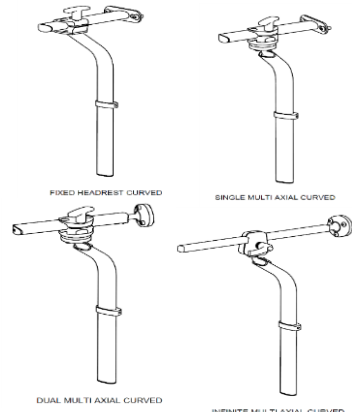
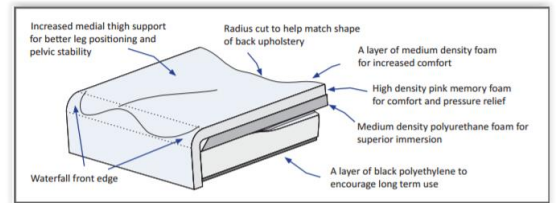

**FOOTNOTES:**

B. Super Chair Kids Aluminum Footplate available for chairs 10"W to 16" W

C. Composite Flip-Up Footplates available for chairs 14" to 16" W

D. Aluminum Flip-Up Footplates available for chairs 12" to 16" W

E. Aluminum Angle Adj. Flip-Up Footplates available for chairs 15"W to 16"W

J. Expandable seat pan available in depths 11-14 and 13-16

Item	Parts #	E-Code	Retail Price
------	---------	--------	--------------

**22. HEADREST ADAPTOR BRACKETS**

- 2 Hole Headrest Adaptor Bracket with Clamp 104HEBA2 - No Charge
- Universal Headrest Adaptor Bracket with Clamp 104HEBA E1028 \$61.00

**23. HEADREST FOAM PAD**

- Omit Headrest Foam Pad 104HE09 - Standard
- Kids Headrest Foam Pad 104HF5 - No Charge
- Small Headrest Foam Pad 104HF1 E0955 No Charge
- Small Headrest with Wings Foam Pad 104HF2 E0955 \$90.00
- Medium Headrest Foam Pad 104HF7 E0955 No Charge
- Medium Headrest with Wings Foam Pad 104HF8 E0955 \$90.00
- Large Headrest Foam Pad 104HF3 E0955 No Charge
- Large Headrest with Wings Foam Pad 104HF4 E0955 \$95.00
- Pro-Fit Small Headrest 109HF12 E0955 \$175.00
- Pro-Fit Med Headrest 109HF13 E0955 \$195.00
- Pro-Fit Large Headrest 109HF14 E0955 \$205.00



**24. ANTI TIP**

- Fixed Anti-Tipper 104MA22 E0971 \$90.00
- Quick FlipUp Anti Tipper 104MA23 E0971 \$120.00

**25. POSITIONING STRAP**

- Auto Seat Positioning Strap 104MA03 E0978 \$52.00
- Airline Seat Positioning Strap 104MA04 E0978 \$76.00
- Velcro Release Positioning Strap 104MA05 E0978 \$48.00

**26. MISCELLANOUS ACCESSORIES**

- Quick Release Axles 104AL1 - \$60.00
- Wheelchair Attachment Tie Down 104MA58 - \$150.00
- Foam Pad on Arm Guard 104MA06 E0978 \$76.00
- Padded Lap Tray 15-16" 104MA09 E0950 \$230.00
- Half Padded Lap Tray, left side 104MA14 E0950 \$160.00
- Half Padded Lap Tray, right side 104MA15 E0950 \$160.00
- IV Pole, Telescopic 104MA20 K0105 \$175.00
- Oxygen Tank Holder 104MA21 E2208 \$175.00
- Spoke Guards available on 20" or 22" wheels 104MA49 - \$130.00
- Additional Link for Headrest 104HE12 E0955 \$50.00
- 2 Additional Links for Headrest 104HE13 E0955 \$100.00
- 3 Additional Links for Headrest 104HE14 E0955 \$150.00



**SEAT TO FLOOR HEIGHT**

STP FRONT (inches)	REAR WHEEL (inches)	CASTER SIZE (inches)	FORK SIZE	FORK HOLE	AXLE PLATE HOLE	STP REAR (inches)
18.50	12	4	LG	C	A	17.25
18.50	12	5	LG	B	A	17.25
19.00	12	7	SML	C	A	17.50
19.50	12	7	LG	B	B	18.25
20.00	12	8	LG	B	B	18.50
17.50	20	4	SML	C	A	15.75
18.00	20	5	SML	C	A	15.75
18.50	22	5	LG	B	A	16.75
19.00	20	7	SML	C	B	17.00
19.50	22	7	LG	B	B	18.00
20.00	22	7	LG	C	B	18.00

**WARRANTY**  
 Future Mobility Healthcare warrants the SuperChair for Kids wheelchair to be free from defects in materials and workmanship for a period of one (1) year from the date of purchase. The frame is warranted for the lifetime of the original purchaser and/or user.